

LOEWS ROYAL PACIFIC RESORT



Meetings & Events



Experience abundant meeting space in the midst of the South Seas at **Loews Royal Pacific Resort at Universal Orlando**. The hotel is home to 1,000 guest rooms and 132,000 square feet of customizable meeting space combining exotic flair with functionality.

ACCOMMODATIONS

- 1,000 guest rooms including 51 suites
- Club Level rooms and suites

HOTEL AMENITIES

- Complimentary WiFi
- Full-service business center
- Full-service concierge
- Self-parking available (*daily fee applies*)
- Complimentary access to the state-of-the-art fitness center
- Lagoon-style pool with sandy beach
- Car rental available on-site

DINING

- **Islands Dining Room** – full-service dining (*private dining options available*)
- **Jake's American Bar**[^] – full-service dining and bar (*private dining options available*)
- **Orchid Court Lounge & Sushi Bar**[^] – full-service dining and bar
- **Bula Bar & Grille**[^] – pool bar and grill
- **Tuk Tuk Market** – grab and go
- **Room service** – available 24 hours a day

EXCLUSIVE THEME PARK BENEFITS

- **Universal Express Unlimited** ride access to skip the regular lines^{††} at participating rides and attractions in Universal Studios Florida and Universal Islands of Adventure (*Valid theme park admission required.*)

- Breeze into one of our theme parks up to an hour early with **Early Park Admission**^{*}. (*Valid theme park admission required. Select attractions.*)
- **Complimentary water taxis** and shuttle buses to the theme parks and Universal CityWalk. (Restrictions apply.)
- **Resort-wide charging** privileges with your room key.
- **Complimentary merchandise delivery**[†] to your hotel from Universal shops.

LOCATION

- 12 miles from downtown Orlando
- 15 miles from Orlando International Airport (MCO)
- 4 miles from the Orange County Convention Center

LOEWS ROYAL PACIFIC RESORT : Floor Plan

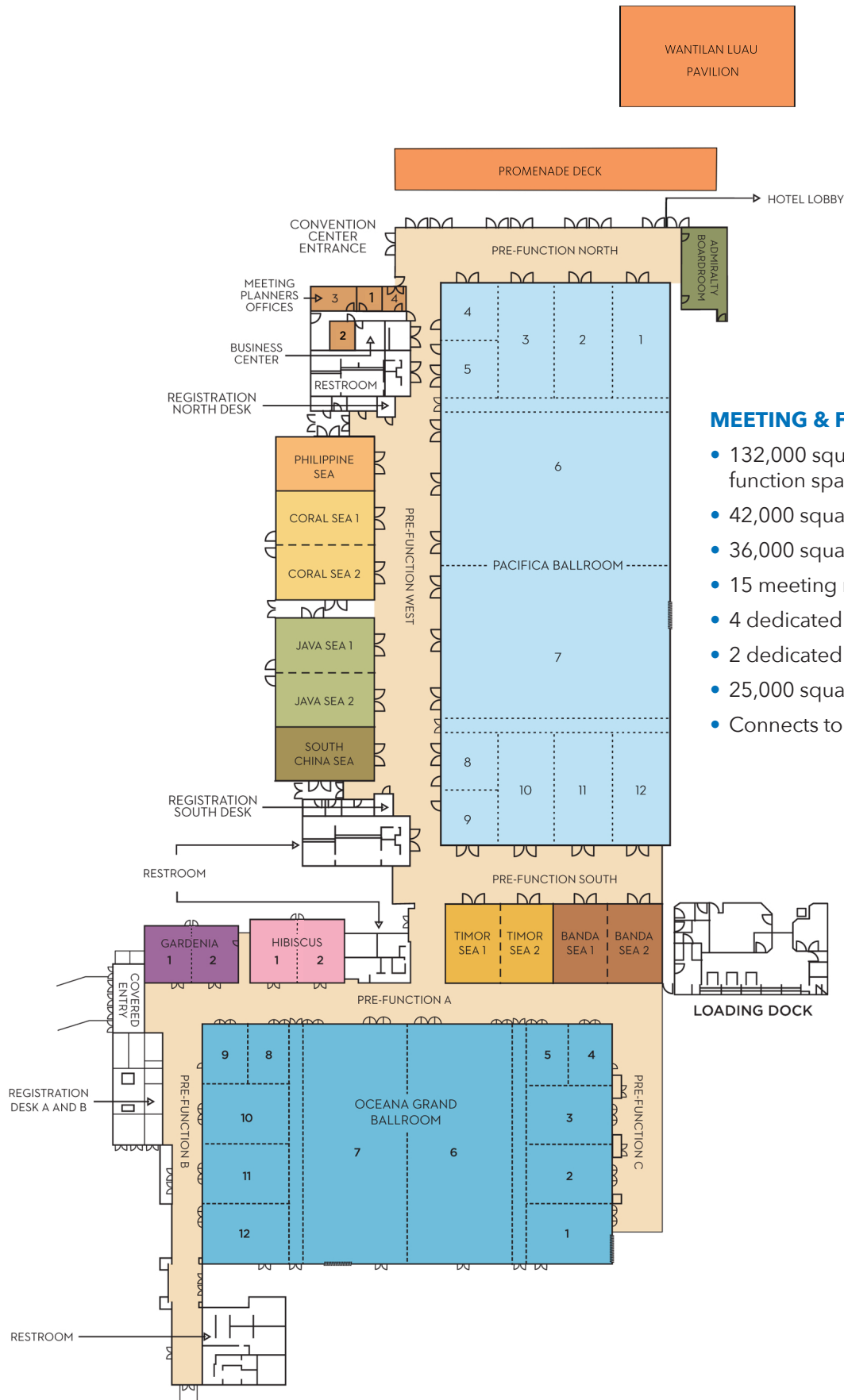

MEETING & FUNCTION SPACE

- 132,000 square feet of meeting and function space
- 42,000 square-foot Pacifica Ballroom
- 36,000 square-foot Oceana Grand Ballroom
- 15 meeting rooms
- 4 dedicated meeting planner offices
- 2 dedicated registration desks
- 25,000 square feet of outdoor meeting space
- Connects to Loews Sapphire Falls Resort

LOEWS ROYAL PACIFIC RESORT : Capacity Chart

NAME	SQUARE FOOTAGE	DIMENSIONS	CEILING HEIGHT	CAPACITIES				
				SCHOOL ROOM	THEATER SEATING	BANQUET (Rounds of 12)	CONFERENCE	RECEPTION
BALLROOMS								
PACIFICA BALLROOM 1-12	41,503	319.25' X 130'	16' 0" / 21' 0"	3,120	5,016	3,564	-	4,150
PACIFICA BALLROOM 1-5 / 8-12	8,450	65' X 130'	16' 0" / 21' 0"	939	840	720	-	845
PACIFICA BALLROOM 1-6 / 7-12	20,752	159.63' X 130'	16' 0" / 21' 0"	1,392	2,376	1,716	-	2,075
PACIFICA BALLROOM 1	2,112	32.5' x 65'	16' 0"	132	232	180	52	211
PACIFICA BALLROOM 2	2,112	32.5' X 65'	16' 0"	132	232	180	52	211
PACIFICA BALLROOM 3	2,112	32.5' X 65'	16' 0"	132	232	180	52	211
PACIFICA BALLROOM 4	1,057	32.5' X 32.5'	16' 0"	60	120	96	22	105
PACIFICA BALLROOM 5	1,057	32.5' X 32.5'	16' 0"	60	120	96	22	105
PACIFICA BALLROOM 6	11,262	86.63' X 130'	21' 0"	900	1,380	924	-	1,126
PACIFICA BALLROOM 7	11,262	86.63' X 130'	21' 0"	900	1,380	924	-	1,126
PACIFICA BALLROOM 8	1,057	32.5' X 32.5'	16' 0"	60	120	96	22	105
PACIFICA BALLROOM 9	1,057	32.5' X 32.5'	16' 0"	60	120	96	22	105
PACIFICA BALLROOM 10	2,112	32.5' X 65'	16' 0"	132	232	180	52	211
PACIFICA BALLROOM 11	2,112	32.5' X 65'	16' 0"	132	232	180	52	211
PACIFICA BALLROOM 12	2,112	32.5' X 65'	16' 0"	132	232	180	52	211
OCEANA GRAND BALLROOM 1 - 12	35,991	248'3" X 144'10"	21' 0"	2,712	3,960	3,042	-	3,000
OCEANA GRAND BALLROOM 1-5 / 8-12	7,452	144'10" X 51'10"	21' 0"	582	858	588	-	625
OCEANA GRAND BALLROOM 1-6 / 7-12	16,575	144'10" X 123'	21' 0"	1,356	1,980	1,512	-	1,500
OCEANA GRAND BALLROOM 1	1,864	51'10" x 35'11"	21' 0"	108	198	156	46	200
OCEANA GRAND BALLROOM 2	1,864	51'10" X 35'10"	21' 0"	108	198	156	46	200
OCEANA GRAND BALLROOM 3	1,864	51'10" X 35'10"	21' 0"	108	198	156	46	200
OCEANA GRAND BALLROOM 4	930	25' 9" X 35'11"	21' 0"	48	84	72	28	90
OCEANA GRAND BALLROOM 5	930	25' 9" X 35'11"	21' 0"	48	84	72	28	90
OCEANA GRAND BALLROOM 6	9,123	63'2" X 144'10"	21' 0"	609	952	720	-	750
OCEANA GRAND BALLROOM 7	9,123	63'2" X 144'10"	21' 0"	609	952	720	-	750
OCEANA GRAND BALLROOM 8	930	25' 9" X 35'11"	21' 0"	48	84	72	28	90
OCEANA GRAND BALLROOM 9	930	25' 9" X 35'11"	21' 0"	48	84	72	28	90
OCEANA GRAND BALLROOM 10	1,864	51'10" X 35'10"	21' 0"	108	198	156	46	200
OCEANA GRAND BALLROOM 11	1,864	51'10" X 35'10"	21' 0"	108	198	156	46	200
OCEANA GRAND BALLROOM 12	1,864	51'10" X 35'11"	21' 0"	108	198	156	46	200
MEETING ROOMS								
PHILIPPINE SEA	1,641	29' X 56'	14' 0"	98	175	144	46	164
CORAL SEA	3,282	59' X 56'	14' 0"	234	358	300	46	328
CORAL SEA 1	1,641	29' X 56'	14' 0"	117	175	144	32	164
CORAL SEA 2	1,641	29' X 56'	14' 0"	117	175	144	32	164
JAVA SEA	3,282	59' X 56'	14' 0"	234	358	300	46	328
JAVA SEA 1	1,641	29' X 56'	14' 0"	117	175	144	32	164
JAVA SEA 2	1,641	29' X 56'	14' 0"	117	175	144	32	164
SOUTH CHINA SEA	1,641	29' X 56'	14' 0"	98	175	144	46	164
BANDA SEA	3,008	47' X 64'	14' 0"	201	322	276	52	300
BANDA SEA 1	1,504	47' X 32'	14' 0"	104	166	120	30	150
BANDA SEA 2	1,504	47' X 32'	14' 0"	104	166	120	30	150
TIMOR SEA	3,008	47' X 64'	14' 0"	201	322	276	52	300
TIMOR SEA 1	1,504	47' X 32'	14' 0"	104	166	120	30	150
TIMOR SEA 2	1,504	47' X 32'	14' 0"	104	166	120	30	150
ADMIRALTY BOARDROOM	898	24' X 33'	14' 0"	24	24	-	24	-
PRE-FUNCTION SPACE	17,364	-	14' 0"	-	-	-	-	1,736
PRE-FUNCTION NORTH	3,150	132' X 22'	14' 0"	-	-	-	-	315
PRE-FUNCTION WEST	11,064	366' X 44'	14' 0"	-	-	-	-	1,106
PRE-FUNCTION SOUTH	3,150	132' X 17'	14' 0"	-	-	-	-	315
MEETING PLANNER OFFICE 1	214	14' X 14'	9' 0"	-	-	-	-	21
MEETING PLANNER OFFICE 2	248	14' X 16'	9' 0"	-	-	-	-	25
MEETING PLANNER OFFICE 3	420	26' X 14'	9' 0"	-	-	-	-	42
MEETING PLANNER OFFICE 4	323	13.7' X 13.1'	9' 0"	-	-	-	-	23
GARDENIA	1910	57' X 33'6"	14' 0"	96	224	120	56	160
GARDENIA 1	956	28'0" X 33'6"	14' 0"	48	112	60	28	80
GARDENIA 2	954	28'0" X 33'6"	14' 0"	48	112	60	28	80
HIBISCUS	2,137	58' X 38'	14' 0"	112	224	144	56	180
HIBISCUS 1	1,065	28'2" X 37'8"	14' 0"	56	112	72	28	90
HIBISCUS 2	1,072	28'2" X 37'8"	14' 0"	56	112	72	28	90
PRE-FUNCTION SPACE	16,371	-	14' 0"	-	-	-	-	-
PRE-FUNCTION A	7,593	24'5" X 251'	14' 0"	-	-	-	-	800
PRE-FUNCTION B	5,173	19' X 220'3"	14' 0"	-	-	-	-	575
PRE-FUNCTION C	2,386	21'4" X 122'5"	14' 0"	-	-	-	-	250
TOTAL: 131,729 SQUARE FEET FOR ALL INDOOR FUNCTION SPACE								
OUTDOOR SPACE								
WANTILAN LUAU PAVILION	6,356	-	-	-	-	-	-	635
PALM GARDEN	3,625	-	-	-	-	-	-	362
PROMENADE DECK	5,000	-	-	-	-	-	-	500
POOL DECK	10,000	-	-	-	-	-	-	1,000
TOTAL: 24,981 SQUARE FEET FOR ALL OUTDOOR FUNCTION SPACE								
TOTAL: 156,710 SQUARE FEET FOR ALL INDOOR AND OUTDOOR FUNCTION SPACE								

CAPACITIES ABOVE REFLECT MAXIMUM SETS ONLY WITH NO AV OR ADDITIONAL REQUIREMENTS.

