

LOEWS MEETING COMPLEX



Meetings & Events

LOEWS SAPPHIRE FALLS RESORT



LOEWS ROYAL PACIFIC RESORT



The Loews Meeting Complex at Universal Orlando connects the meeting space of **Loews Sapphire Falls Resort** and **Loews Royal Pacific Resort**, offering a total of 2,000 rooms and 247,000 square feet of meeting space. Take advantage of both hotels' large ballrooms and array of meeting and breakout rooms while your group enjoys the comfort and convenience of staying in one or both of the attached hotels.

LOEWS MEETING COMPLEX AT UNIVERSAL ORLANDO

LOCATION

- On-site at Universal Orlando Resort
- 12 miles from downtown Orlando
- 15 miles from Orlando International Airport (MCO)
- 4 miles from the Orange County Convention Center

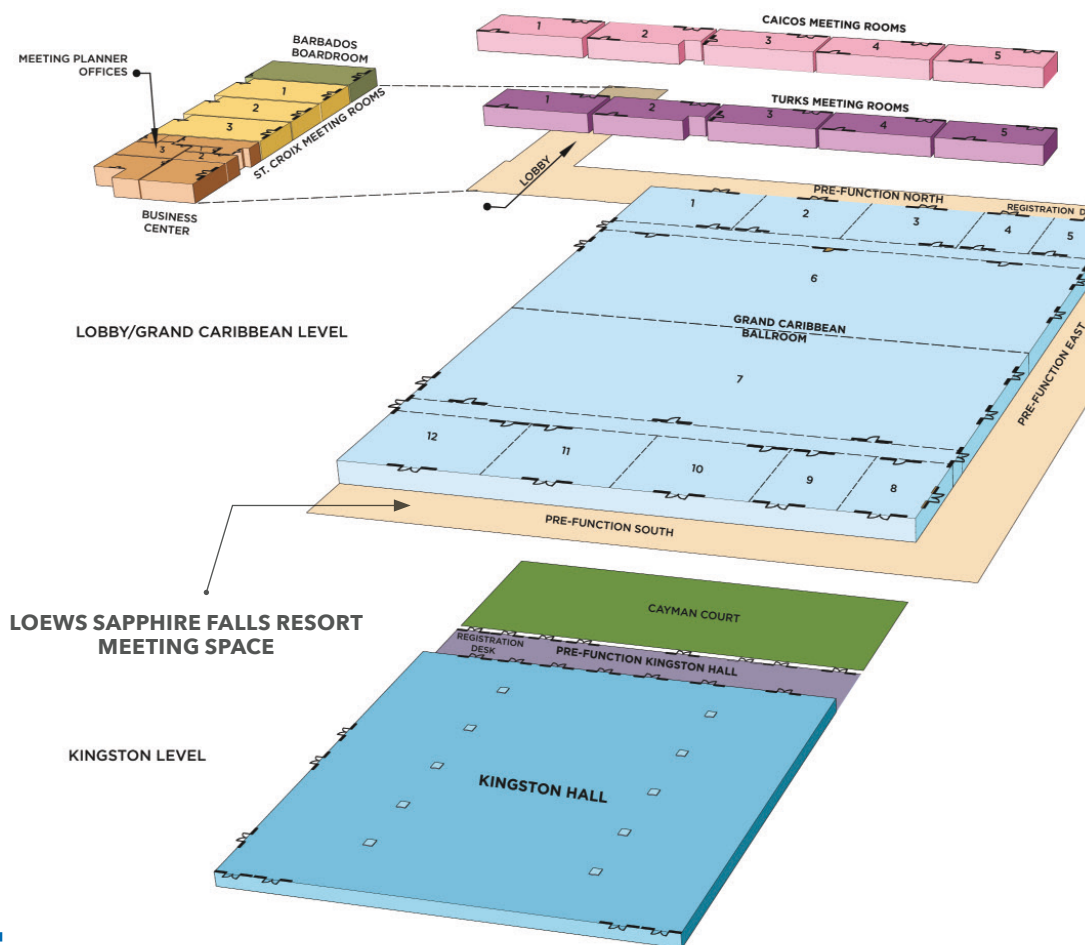

LOEWS SAPPHIRE FALLS RESORT

The Caribbean-themed Loews Sapphire Falls Resort at Universal Orlando Resort offers 1,000 rooms and 115,000 square feet of meeting space. The lush, tropical feel of the hotel is seamlessly carried over into the meeting areas, featuring traditional island styling with modern touches.

ACCOMMODATIONS

- 1,000 guest rooms including 83 suites

HOTEL AMENITIES

- Complimentary WiFi
- Full-service business center
- Full-service concierge
- Self-parking available (*daily fee applies*)
- Complimentary access to the state-of-the-art fitness center
- Resort-style pool with waterfalls and white sandy beaches
- Car rental available on-site

DINING

- **Amatista Cookhouse™** - full-service (*private dining options available*)
- **New Dutch Trading Co.™** - grab and go
- **Drhum Club Kantine** - pool bar and grill
- **Strong Water Tavern** - lobby lounge
- **Room service** - available 24 hours a day

EXCLUSIVE THEME PARK BENEFITS

- Breeze into one of our theme parks up to an hour early with **Early Park Admission***. (*Valid theme park admission required. Select attractions.*)
- **Complimentary water taxis** and shuttle buses to the theme parks and Universal CityWalk
- **Resort-wide charging** privileges with your room key
- **Complimentary merchandise delivery** to your hotel from Universal shops

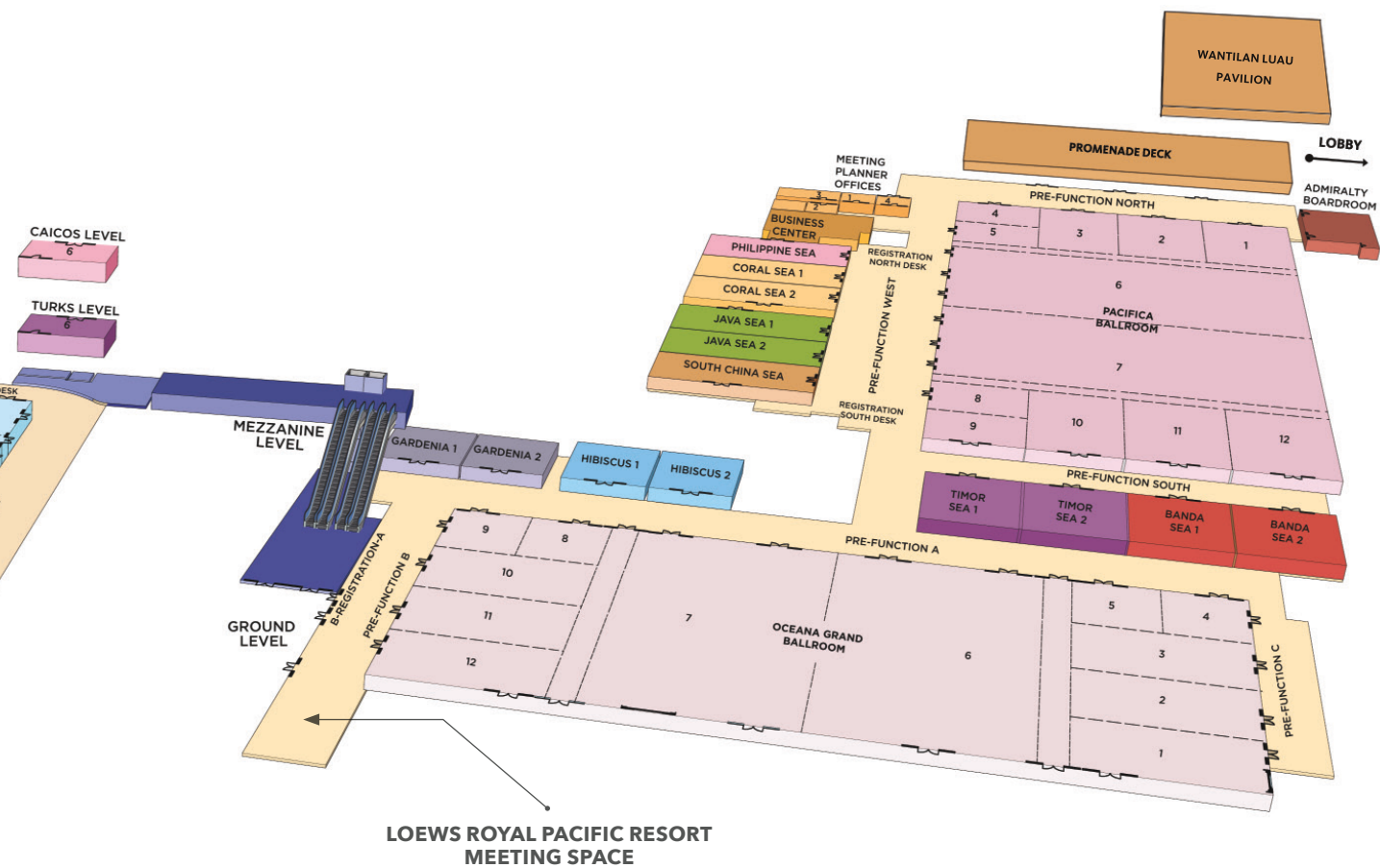

LOEWS ROYAL PACIFIC RESORT MEETING SPACE

LOEWS ROYAL PACIFIC RESORT

Experience abundant meeting space in the midst of the South Seas at Loews Royal Pacific Resort at Universal Orlando. The hotel is home to 1,000 guest rooms and 132,000 square feet of customizable meeting space combining exotic flair with functionality.

ACCOMMODATIONS

- 1,000 guest rooms including 51 suites
- Club Level rooms and suites

HOTEL AMENITIES

- Complimentary WiFi
- Full-service business center
- Full-service concierge
- Self-parking available (*daily fee applies*)
- Complimentary access to the state-of-the-art fitness center
- Lagoon-style pool with sandy beach
- Car rental available on-site

DINING

- **Islands Dining Room** - full-service (*private dining options available*)
- **Jake's American Bar** - full-service dining (*private dining options available*)
- **Orchid Court Lounge & Sushi Bar** - bar/lounge
- **Bula Bar & Grille** - pool bar and grill
- **Tuk Tuk Market** - grab and go
- **Room service** - available 24 hours a day

EXCLUSIVE HOTEL GUEST BENEFITS

- **Universal Express Unlimited** ride access to skip the regular lines^{††} in Universal Studios Florida and Universal Islands of Adventure - a free[†] benefit worth up to \$164.99 per person, per day. (*Valid theme park admission required.*)
- Breeze into one of our theme parks up to an hour early with **Early Park Admission***. (*Valid theme park admission required. Select attractions.*)
- **Complimentary water taxis** and shuttle buses to the theme parks and Universal CityWalk.
- **Resort-wide charging** privileges with your room key.
- **Complimentary merchandise delivery** to your hotel from Universal shops.

LOEWS SAPPHIRE FALLS RESORT : Floor Plan

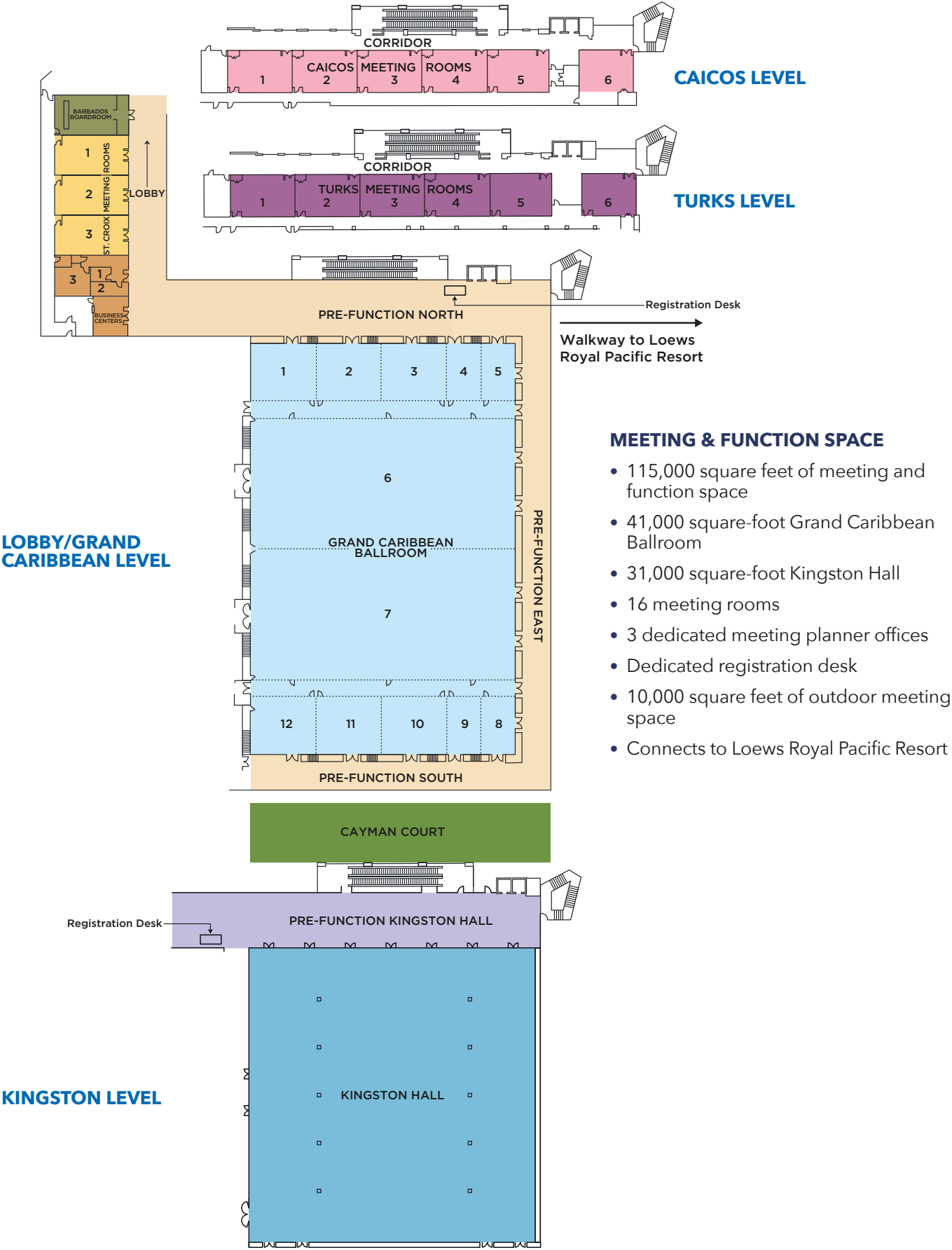

MEETING & FUNCTION SPACE

- 115,000 square feet of meeting and function space
- 41,000 square-foot Grand Caribbean Ballroom
- 31,000 square-foot Kingston Hall
- 16 meeting rooms
- 3 dedicated meeting planner offices
- Dedicated registration desk
- 10,000 square feet of outdoor meeting space
- Connects to Loews Royal Pacific Resort

LOEWS SAPPHIRE FALLS RESORT : Capacity Chart

NAME	SQUARE FOOTAGE	DIMENSIONS	CEILING HEIGHT	CAPACITIES				
				SCHOOL ROOM	THEATER SEATING	BANQUET (Rounds of 12)	CONFERENCE	RECEPTION
BALLROOMS								
GRAND CARIBBEAN 1-12	40,713	161'X254'	28'	3,264	4,523	3,384	-	4,071
GRAND CARIBBEAN 1-5	5,257	33'X161'	28'	315	584	384	100	525
GRAND CARIBBEAN 1-6	17,827	126'X161'	28'	1,440	2,100	1,512	-	1,782
GRAND CARIBBEAN 7-12	18,061	127'X161'	28'	1,440	2,100	1,512	-	1,806
GRAND CARIBBEAN 8-12	5,233	33'X161'	28'	315	581	384	100	523
GRAND CARIBBEAN 1	1,320	33'X40'	28'	75	146	96	30	132
GRAND CARIBBEAN 2	1,314	33'X40'	28'	75	146	96	30	131
GRAND CARIBBEAN 3	1,319	33'X40'	28'	75	146	96	30	131
GRAND CARIBBEAN 4	649	33'X20'	28'	36	72	48	20	64
GRAND CARIBBEAN 5	655	33'X20'	28'	36	72	48	20	65
GRAND CARIBBEAN 6	12,570	79'X161'	28'	894	1,396	936	-	1,257
GRAND CARIBBEAN 7	12,828	80'X161'	28'	900	1,425	924	-	1,282
GRAND CARIBBEAN 8	655	33'X20'	28'	36	72	48	20	65
GRAND CARIBBEAN 9	649	33'X20'	28'	36	72	48	20	64
GRAND CARIBBEAN 10	1,319	33'X40'	28'	75	146	96	30	131
GRAND CARIBBEAN 11	1,314	33'X40'	28'	75	144	96	30	131
GRAND CARIBBEAN 12	1,296	33'X40'	28'	75	144	96	30	129
PRE-FUNCTION NORTH	9,274	37'X252'	14'	-	-	-	-	927
PRE-FUNCTION EAST	5,206	20'X266'	14'	-	-	-	-	520
PRE-FUNCTION SOUTH	3,676	20'X172'	14'	-	-	-	-	367
MEETING ROOMS								
PLANNER OFFICE 1	106	8'X13'	10'	-	-	-	-	10
PLANNER OFFICE 2	183	9'X22'	10'	-	-	-	-	18
PLANNER OFFICE 3	381	17'X22'	10'	-	-	-	-	38
PLANNER LOBBY	206	6'X26'	10'	-	-	-	-	20
BARBADOS BOARDROOM	970	24'X45'	14'	-	-	-	16	-
KINGSTON HALL	29,736	168'X177'	20'	2,340	3,150	2,400	-	3,120
PRE-FUNCTION KINGSTON HALL	9,092	38'X251'	22'	-	-	-	-	909
TURKS 1	883	25'X39'	14'	54	64	60	20	64
TURKS 2	849	25'X40'	14'	54	60	60	20	60
TURKS 3	760	22'X40'	14'	36	56	48	20	56
TURKS 4	731	22'X40'	14'	36	54	48	20	54
TURKS 5	704	22'X39'	14'	33	52	48	20	52
TURKS 6	729	25'X33'	14'	36	52	48	20	52
CAICOS 1	869	25'X39'	14'	54	62	60	20	62
CAICOS 2	887	25'X40'	14'	54	63	60	20	63
CAICOS 3	887	25X40'	14'	54	63	60	20	63
CAICOS 4	887	25'X40'	14'	54	63	60	20	63
CAICOS 5	856	25'X38'	14'	54	61	60	20	61
CAICOS 6	910	33'X33'	14'	57	66	60	16	66
ST. CROIX 1	992	24'X45'	14'	60	69	60	24	69
ST. CROIX 2	992	24'X45'	14'	60	69	60	24	69
ST. CROIX 3	992	24'X45'	14'	60	69	60	24	69
TOTAL: 114,885 SQUARE FEET FOR ALL INDOOR FUNCTION SPACE								
OUTDOOR SPACE								
CAYMAN COURT PAVILION	4,130	-	-	-	-	288	-	413
CAYMAN COURT LAWN	5,500	-	-	-	-	360	-	550
CAYMAN COURT TERRACE	3,732	-	-	-	-	-	-	300
TOTAL: 9,630 SQUARE FEET FOR ALL OUTDOOR FUNCTION SPACE								
TOTAL: 124,515 SQUARE FEET FOR ALL INDOOR AND OUTDOOR FUNCTION SPACE								

CAPACITIES ABOVE REFLECT MAXIMUM SETS ONLY WITH NO AV OR ADDITIONAL REQUIREMENTS.

LOEWS ROYAL PACIFIC RESORT : Floor Plan

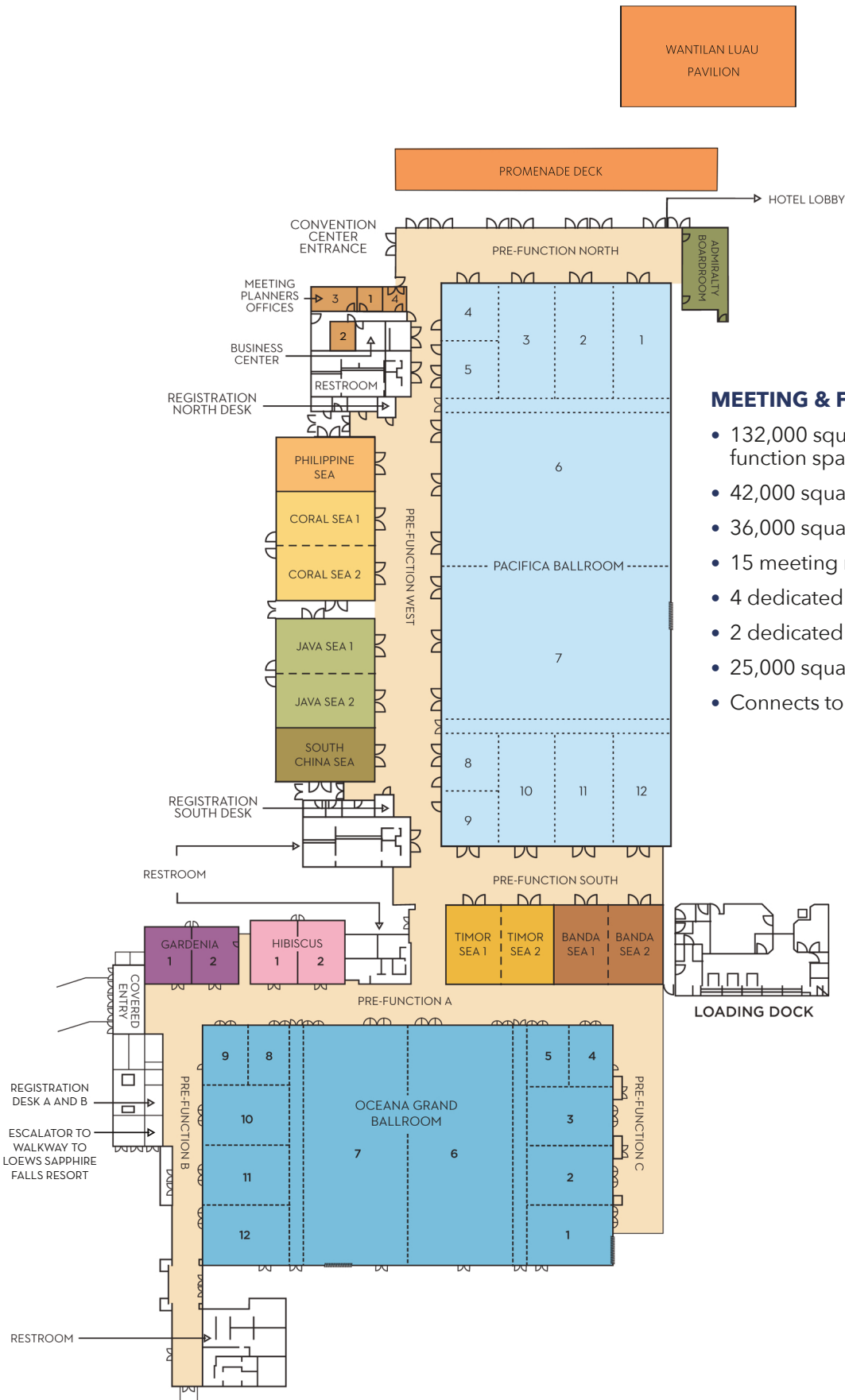

MEETING & FUNCTION SPACE

- 132,000 square feet of meeting and function space
- 42,000 square-foot Pacifica Ballroom
- 36,000 square-foot Oceana Grand Ballroom
- 15 meeting rooms
- 4 dedicated meeting planner offices
- 2 dedicated registration desks
- 25,000 square feet of outdoor meeting space
- Connects to Loews Sapphire Falls Resort

LOEWS ROYAL PACIFIC RESORT : Capacity Chart

NAME	SQUARE FOOTAGE	DIMENSIONS	CEILING HEIGHT	CAPACITIES				
				SCHOOL ROOM	THEATER SEATING	BANQUET (Rounds of 12)	CONFERENCE	RECEPTION
BALLROOMS								
PACIFICA BALLROOM 1-12	41,503	319.25' X 130'	16' 0" / 21' 0"	3,120	5,016	3,564	-	4,150
PACIFICA BALLROOM 1-5 / 8-12	8,450	65' X 130'	16' 0" / 21' 0"	939	840	720	-	845
PACIFICA BALLROOM 1-6 / 7-12	20,752	159.63' X 130'	16' 0" / 21' 0"	1,392	2,376	1,716	-	2,075
PACIFICA BALLROOM 1	2,112	32.5' x 65'	16' 0"	132	232	180	52	211
PACIFICA BALLROOM 2	2,112	32.5' X 65'	16' 0"	132	232	180	52	211
PACIFICA BALLROOM 3	2,112	32.5' X 65'	16' 0"	132	232	180	52	211
PACIFICA BALLROOM 4	1,057	32.5' X 32.5'	16' 0"	60	120	96	22	105
PACIFICA BALLROOM 5	1,057	32.5' X 32.5'	16' 0"	60	120	96	22	105
PACIFICA BALLROOM 6	11,262	86.63' X 130'	21' 0"	900	1,380	924	-	1,126
PACIFICA BALLROOM 7	11,262	86.63' X 130'	21' 0"	900	1,380	924	-	1,126
PACIFICA BALLROOM 8	1,057	32.5' X 32.5'	16' 0"	60	120	96	22	105
PACIFICA BALLROOM 9	1,057	32.5' X 32.5'	16' 0"	60	120	96	22	105
PACIFICA BALLROOM 10	2,112	32.5' X 65'	16' 0"	132	232	180	52	211
PACIFICA BALLROOM 11	2,112	32.5' X 65'	16' 0"	132	232	180	52	211
PACIFICA BALLROOM 12	2,112	32.5' X 65'	16' 0"	132	232	180	52	211
OCEANA GRAND BALLROOM 1 - 12	35,991	248'3" X 144'10"	21' 0"	2,712	3,960	3,042	-	3,000
OCEANA GRAND BALLROOM 1-5 / 8-12	7,452	144'10" X 51'10"	21' 0"	582	858	588	-	625
OCEANA GRAND BALLROOM 1-6 / 7-12	16,575	144'10" X 123'	21' 0"	1,356	1,980	1,512	-	1,500
OCEANA GRAND BALLROOM 1	1,864	51'10" x 35'11"	21' 0"	108	198	156	46	200
OCEANA GRAND BALLROOM 2	1,864	51'10" X 35'10"	21' 0"	108	198	156	46	200
OCEANA GRAND BALLROOM 3	1,864	51'10" X 35'10"	21' 0"	108	198	156	46	200
OCEANA GRAND BALLROOM 4	930	25' 9" X 35'11"	21' 0"	48	84	72	28	90
OCEANA GRAND BALLROOM 5	930	25' 9" X 35'11"	21' 0"	48	84	72	28	90
OCEANA GRAND BALLROOM 6	9,123	63'2" X 144'10"	21' 0"	609	952	720	-	750
OCEANA GRAND BALLROOM 7	9,123	63'2" X 144'10"	21' 0"	609	952	720	-	750
OCEANA GRAND BALLROOM 8	930	25' 9" X 35'11"	21' 0"	48	84	72	28	90
OCEANA GRAND BALLROOM 9	930	25' 9" X 35'11"	21' 0"	48	84	72	28	90
OCEANA GRAND BALLROOM 10	1,864	51'10" X 35'10"	21' 0"	108	198	156	46	200
OCEANA GRAND BALLROOM 11	1,864	51'10" X 35'10"	21' 0"	108	198	156	46	200
OCEANA GRAND BALLROOM 12	1,864	51'10" X 35'11"	21' 0"	108	198	156	46	200
MEETING ROOMS								
PHILIPPINE SEA	1,641	29' X 56'	14' 0"	98	175	144	46	164
CORAL SEA	3,282	59' X 56'	14' 0"	234	358	300	46	328
CORAL SEA 1	1,641	29' X 56'	14' 0"	117	175	144	32	164
CORAL SEA 2	1,641	29' X 56'	14' 0"	117	175	144	32	164
JAVA SEA	3,282	59' X 56'	14' 0"	234	358	300	46	328
JAVA SEA 1	1,641	29' X 56'	14' 0"	117	175	144	32	164
JAVA SEA 2	1,641	29' X 56'	14' 0"	117	175	144	32	164
SOUTH CHINA SEA	1,641	29' X 56'	14' 0"	98	175	144	46	164
BANDA SEA	3,008	47' X 64'	14' 0"	201	322	276	52	300
BANDA SEA 1	1,504	47' X 32'	14' 0"	104	166	120	30	150
BANDA SEA 2	1,504	47' X 32'	14' 0"	104	166	120	30	150
TIMOR SEA	3,008	47' X 64'	14' 0"	201	322	276	52	300
TIMOR SEA 1	1,504	47' X 32'	14' 0"	104	166	120	30	150
TIMOR SEA 2	1,504	47' X 32'	14' 0"	104	166	120	30	150
ADMIRALTY BOARDROOM	898	24' X 33'	14' 0"	24	24	-	24	-
PRE-FUNCTION SPACE	17,364	-	14' 0"	-	-	-	-	1,736
PRE-FUNCTION NORTH	3,150	132' X 22'	14' 0"	-	-	-	-	315
PRE-FUNCTION WEST	11,064	366' X 44'	14' 0"	-	-	-	-	1,106
PRE-FUNCTION SOUTH	3,150	132' X 17'	14' 0"	-	-	-	-	315
MEETING PLANNER OFFICE 1	214	14' X 14'	9' 0"	-	-	-	-	21
MEETING PLANNER OFFICE 2	248	14' X 16'	9' 0"	-	-	-	-	25
MEETING PLANNER OFFICE 3	420	26' X 14'	9' 0"	-	-	-	-	42
MEETING PLANNER OFFICE 4	323	13.7' X 13.1'	9' 0"	-	-	-	-	23
GARDENIA	1910	57' X 33'6"	14' 0"	96	224	120	56	160
GARDENIA 1	956	28'0" X 33'6"	14' 0"	48	112	60	28	80
GARDENIA 2	954	28'0" X 33'6"	14' 0"	48	112	60	28	80
HIBISCUS	2,137	58' X 38'	14' 0"	112	224	144	56	180
HIBISCUS 1	1,065	28'2" X 37'8"	14' 0"	56	112	72	28	90
HIBISCUS 2	1,072	28'2" X 37'8"	14' 0"	56	112	72	28	90
PRE-FUNCTION SPACE	16,371	-	14' 0"	-	-	-	-	-
PRE-FUNCTION A	7,593	24'5" X 251'	14' 0"	-	-	-	-	800
PRE-FUNCTION B	5,173	19' X 220'3"	14' 0"	-	-	-	-	575
PRE-FUNCTION C	2,386	21'4" X 122'5"	14' 0"	-	-	-	-	250
TOTAL: 131,729 SQUARE FEET FOR ALL INDOOR FUNCTION SPACE								
OUTDOOR SPACE								
WANTILAN LUAU PAVILION	6,356	-	-	-	-	-	-	635
PALM GARDEN	3,625	-	-	-	-	-	-	362
PROMENADE DECK	5,000	-	-	-	-	-	-	500
POOL DECK	10,000	-	-	-	-	-	-	1,000
TOTAL: 24,981 SQUARE FEET FOR ALL OUTDOOR FUNCTION SPACE								
TOTAL: 156,710 SQUARE FEET FOR ALL INDOOR AND OUTDOOR FUNCTION SPACE								

CAPACITIES ABOVE REFLECT MAXIMUM SETS ONLY WITH NO AV OR ADDITIONAL REQUIREMENTS.

WHERE MEETING PLANNERS BECOME HEROES



TOUR OUR HOTELS



Meetings & Events

LOEWS HOTELS & CO
ESTABLISHED 1960



LOEWS ROYAL PACIFIC RESORT
6300 Hollywood Way
Orlando, Florida 32819



LOEWS SAPPHIRE FALLS RESORT
6601 Adventure Way
Orlando, Florida 32819

HARRY POTTER and all related characters and elements © & ™ Warner Bros. Entertainment Inc. Publishing Rights © J.K. Rowling.
 *Valid theme park admission and Universal Orlando hotel validation required. Early Park Admission begins up to one (1) hour prior to regular scheduled park opening to: (a) Universal Studios Florida and/or Universal Islands of Adventure as determined by Universal Orlando; (b) Universal Volcano Bay (weather permitting); and/or (c) Universal Epic Universe (opening 2025). Valid at select attractions at each park. Park-to-Park admission required to board the Hogwarts™ Express. Benefit is non-transferable. Parks, attractions, operational times, and offerings for the Early Park Admission benefit may vary and are subject to substitutions, change, availability, capacity and/or cancellation without notice, and not guaranteed. Additional restrictions may apply. Hard Rock Hotel © Hard Rock Cafe International (USA), Inc. Portofino Bay Hotel and Royal Pacific Resort TM & © 2024 UCF Hotel Venture. Cabana Bay Beach Resort TM & © 2024 UCF Hotel Venture II. Sapphire Falls Resort TM & © 2024 UCF Hotel Venture III. Aventura Hotel TM & © 2024 UCF Hotel Venture IV. © 2024 UCF Hotel Venture V. UNIVERSAL TM & © Universal Studios. ENDLESS SUMMER registered trademarks, Bruce Brown Films, LLC. Universal elements and all related indicia TM & © 2024 Universal Studios. All rights reserved. 24-UOR-16605784/RG